



46 Meadway Court  
Worthing, BN13 1PP

Offers over £200,000



## 46 Meadway Court Worthing, BN13 1PP

James & James Estate Agents are pleased to bring to the market this spacious & well presented first floor flat.

In brief, the accommodation comprises; A security entry phone providing access to the communal hall and stairs to the first floor, Entrance hall , West facing Lounge, fitted kitchen & utility room, two double bedrooms and a bathroom/wc.

Outside the flat benefits from a garage and attractive communal gardens. Situated in the ever popular Goring area within a few minutes walk of local shopping facilities and a main line railway station. Local schools and bus services are also close at hand. Worthing town centre with its many and varied shopping facilities and other amenities are within a short drive. The sea front is also close at hand.

Beautiful Presented First Floor Flat

Entry Phone system

West Facing Lounge

Kitchen/Breakfast Room

Utility Room

Two Double Bedrooms

Re-Fitted Bathroom/WC

Double Glazing

Garage

Long Lease 999 Years From 1958

Lounge / Diner  
17'0 x 11'11 (5.18m x 3.63m)





Bedroom One  
13'10 x 12'6 (4.22m x 3.81m)

Bedroom Two  
11'11 x 10'5 (3.63m x 3.18m)

Kitchen  
8'5 x 10'5 (2.57m x 3.18m )

Utility Room

Garage

Remainder of a 999 year lease

## Floor Plan

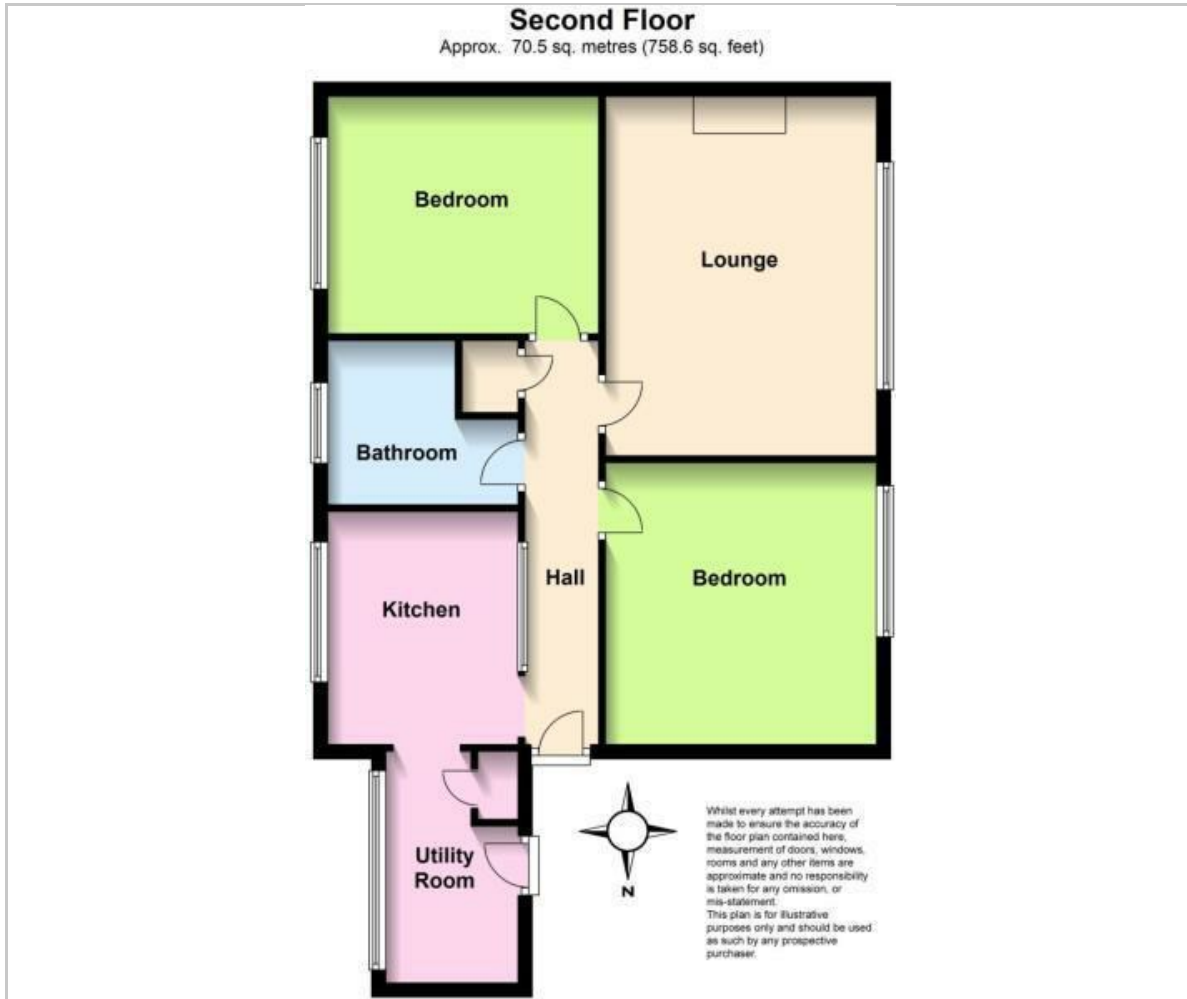

## Viewing

Please contact our Worthing Office on 01903 958770 if you wish to arrange a viewing appointment for this property or require further information.

These particulars, whilst believed to be accurate are set out as a general outline only for guidance and do not constitute any part of an offer or contract. Intending purchasers should not rely on them as statements of representation of fact, but must satisfy themselves by inspection or otherwise as to their accuracy. No person in this firm's employment has the authority to make or give any representation or warranty in respect of the property.

## Area Map



## Energy Efficiency Graph

